

R 28

T. 137

T. 138

Harold Curo
1918

Grinols Survey

IVY LEAF

19

No. 1201

D. P. 7 N 22 E 57 27.62
L. P. 7 N 2 W 40 29.70
H. P. 8 15 E 61

48

6

270

97

270

57

6

342

342

376

T. 137 + 138 R. 2811

Aug. 17-1918

Saturday

I take train from Brainerd
and go to Pine River and
stay at Will Stein
on Sunday go to court
see 27-28-33 & 34-138-28

Monday Morning

Sunday 18-1918
in Pine River all
day do not work.

Harold G. Curo

T 1378-138 R. 28.

Monday Aug. 19, 1919

Will Hauvols B. Hauvols

Myron Stevens

and I go in Ford car
to see cor between sec
27-28-33-34-138-28

which was a spike in the
center of gradet road, and
the grader pulled out the spike
so could not find it soon.

Myron Stevens and B. Hauvols

and I go one mile south
to cor between sec. 33 & 28

on Town line and run

North from it quite far

right at twenty minutes to

six. Will Hauvols goes

to town and tries to buy

tractor.

Harold J. Curo

T. 137-138 R. 28

Tuesday, Aug. 20, 1918

Rains all day do not work
all day at Carpenters

Harold J. Curo

Wed. Aug 21, 1918

Will Grinols B. Grinols

Myron Stevens and I continue

line N between sec 33 & 34

T. 138 R. 28. @ 62 N with W

edge of bog, @ 160 N to same

@ 622.70 N Hub. @ 1104.40 N

Hub. @ 1689 N center of field

@ 1733.80 N Hub.

@ 2181.70 N Hub.

@ 2829.50 N Hub.

@ 3279.60 N Hub quiet

for night 6.30

Harold J. Curo

T. 137-138 R. 28

Aug 22, 1918

Same crew
finish line between sec
33 & 34

@ 4266.10 N Hub.

@ 5280 N Hub.

Can not find No tests
can go to S W cor. of
sec 33 and run N on
line between sec 32 & 33

T 138 R 28,

@ 788.50 N Hub.

@ 1322.50 N Hub.

Quiet for Night @

6.00 old records

Made because we did
not go faster when I came
up with transit he look up
and said that there was
no hub there and I told him
it was quieting time he
said it was only 6.00

T. 138-137 R. 28.
Time Sheet

	17	18	19	20	21	22	23	24	25	26	27	28	29	30	1911
Aug															
Hobbs J. Curo	1	0	1	0	1	1	1	1							
express	9 ⁰¹	0	0	5 ⁰⁸											
Myron Stevens	0	0	1	0	1	1	1	1							
B. M. Mairde	0	0	1	0	1	1	1	1							
Bill Mairde	0	0	1	0	1	1	1	1							
Mairde Psa	0	0	1	0	1	1	1	1							

Aug 22 1918

I and I told him
that we was to be home
at 5.0 clock he said he
did not give a damn
what time we was to be
home. keep on at work
and walk home. he come
a little later in car. with
crew.

Harold J. Curo

T. 137-138 R 28

Aug 23, 1918.

finish cutting line No
mile down crew

© 2219.90 N Hub

© 3140 20 N Hub

© 4393, 30 N Hub

© 5280 stake look for NSP
which are

Ask 7 N 70 E 15 LR = 990 ft

" - N 20 W 22 " = 10,520 ft

" - S 85 E 20 " = 13,200 ft

" - S 20 W 20 " = 13,200 ft

can not find any of
them Gindels said he
would not ~~in~~ with the bush.
any more will stop the
survey first go to dinner

correct line
set 33834

Corrections are:

52738 0 N goes East 197.40

1 ft N goes E, 0 3743 ft

H.C.

Boarding Mrs. Hoet Carpenter

Aug 17 18 19 20 21 22 23 24 25 26 27 28 29 30
 Hoet Jr. 0 0 5 9 9 5 8 8 8 8 8 8 8 8 8

Aug 23.

Collections

300	N	gross	E	11.23	✓
600	N	"	"	22.46	"
900	N	"	"	33.69	"
1200	"	"	"	44.92	"
1318.45	N	"	"	49.35	"
1500	N	gross	"	56.15	"
1800	"	"	"	67.37	"
2100	"	"	"	78.60	"
2400	"	"	"	89.83	"
2636.90	N	gross	"	98.70	"
2700	N	gross	"	101.10	"
3000	"	"	"	112.30	"
3300	"	"	"	123.63	"
3600	"	"	"	134.85	"
3900	"	"	"	146.10	"
3955.35	N	gross	E	148.10	"
4200	N	gross	E	157.21	"
4500	"	"	"	168.43	"
4800	"	"	"	179.65	"
5100	"	"	"	190.89	"
5273.80	N	gross	E	197.40	"

Harold P. Curo

29

28

27

32

34

L 77c

5

3

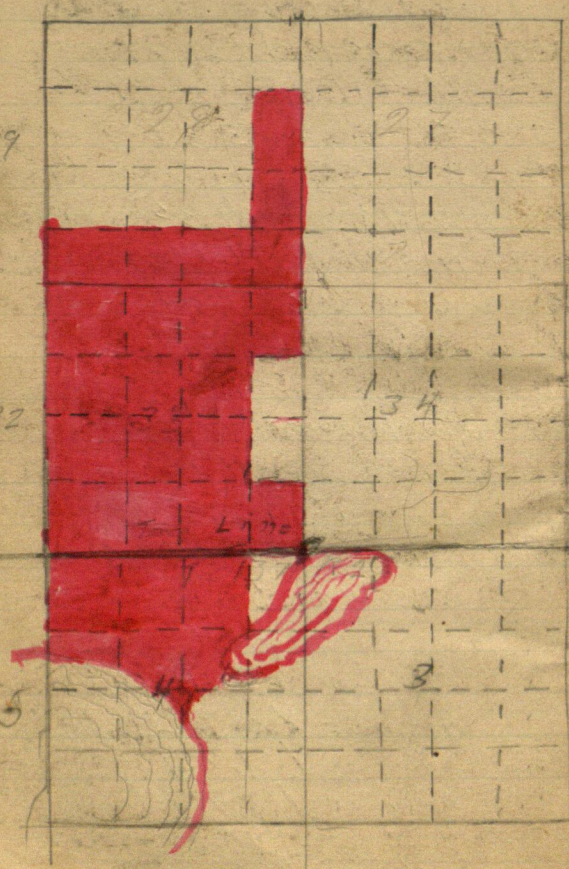

T 137-138 R. 28

11

Aug 24, 1918

Go to work but
when we get to con.

Minerals says we will
not go on with survey
any longer unless I see
the 300 ft ch. and ch.
over all the brush I told
him I would NOT but
I would ch over the brush
with the 100 he says
no & brings me to town
will not pay we said
who would settle with
my father I go to
Brainard on train

Harold Jr. Case

Minerals goes to Hill.

Where he belongs

(1)

Sept 21-1937

Thursday morning

9-15 am.

Herb Kemper and
I to Jenkins

Red cloth at Pegwood
19th. On Nirrova 9-40

am. Mahlum Stör

Call Brainerd

Highway Dept to
Clarence Hodge Ho

morning

Call

Minnesota Highway Dept
Div Engr 305 Laurel St
1107. Moulster

office answers and
says Mr. Somebody
is out and is hard
to get after dinner

Clarence will have
to drive down in am.

14

(2)

I also call
 Eunice Gould Curo
 at Ridley's
 Sheriff's home at Copier
 275. Talked to
 Mrs Ridley - then
 Eunice Reed in
 at Evelith

Jerry Volstad
 Forister ~~But~~
 or
 Mansfield 4751

He says see
 Jack Hubbard

Head Forister Beard
 about filling up big
 hole at en

~~5-6-7-8-135-29~~

1-6-7-12-135-134-29-30

1-6-7-12-134-29-30

USNalis call for

"Y" 134-29.

Pine 24 N 47 E 23

" 24 S 63 E 24

" 36 N 73 W 34

" 34 S 20 W 6

35

32

366
4

128

2775

~~74.04~~

35

4
11 1.00

~~7.8.6~~

1.63

15

42.1 6.00

16

42

32

64

672

70
15
11
5
138

Mrs. Riley Carpenter.
Pine River.
Minn.
Swainburg Court.

V 3955.35 N 90° E 148.10
V 4200 N 90° E 157.21 ft
4500 N 90° E 168.43 ft
4800 N 90° E 179.65 ft
5100 N 90° E 190.89 ft
5273.80 N 90° E 197.40 ft

Corrections on the
line between sec. 33 & 34.

5273.80 N goes E 197.40
ft. to sec cor to sec 33-34 -
27628.

1 ft N goes E = 0.3743 ft.
300 N " E = 11.23 ft.
600 N " E = 22.46 ft.
900 N " E = 33.69 ft.
1200 N " E = 44.92 ft.
1500 N " E = 56.15 ft.
1800 N " E = 67.37 ft.
2100 N " E = 78.60 ft.
2400 N " E = 89.83 ft.
2636.90 North goes East = 98.70 ft.
2700 N goes E 101.10 ft.
3000 N " E 112.30 ft.
3300 N " E 123.63 ft.
3600 N " E 134.85 ft.
3900 N " E 146.10 ft.
51318.45 N goes E 49,35 ft.

52738 $\sqrt{197400}$ ⁰³⁷⁴³
158214

391860

369166

226940

210952

~~52738~~

159880

26369

2

3743

3

63252738

3743

9

33687

525

52739

7

158214

369166

1122900

3743

6

22458

3

28-29-32 & 33

Ash. 7. N 70 E 15 LK. = 9.90

Ash. - N 20 W 22 LK. = 16.53 ft

Ash. - S 85 E 20 LK. = 13.20 ft

Ash. - S 20 W 20 LK. = 13.20 ft

$$\begin{array}{r}
 22 \quad 3 \quad 15 - \\
 \underline{6} \quad \underline{6} \quad \underline{0} \\
 132 \quad 90 \\
 \hline
 165 - 2
 \end{array}$$

$$\begin{array}{r}
 20 \\
 \underline{6} \\
 120 \\
 \underline{120} \\
 1320
 \end{array}$$

$$\begin{array}{r}
 48 \\
 \underline{6} \\
 108 \\
 \underline{108} \\
 1128 \\
 \underline{3} \\
 75 \\
 \underline{6} \\
 450 \\
 \underline{450} \\
 4950
 \end{array}$$

$$\begin{array}{r}
 198 \\
 \underline{6} \\
 1188 \\
 \underline{1188} \\
 13068 \\
 \underline{83} \\
 6 \\
 \underline{498} \\
 478 \\
 \underline{478} \\
 5478
 \end{array}$$

- 120
- East
- ~~62 FT Noster~~
- ~~@ 160 N N 2nd name~~
- ~~@ 622.70 N Hub~~
- ~~@ 1104.40 N "~~
- ~~@ 1689 N Center of fall line~~
- ~~@ 1733.20 N Hub~~
- ~~@ 2121.70 N Hub~~
- ~~@ 2829.50 N Hub~~
- ~~@ 3279.60 N Hub~~

- East
- ~~@ 4266.10 N Hub~~
- ~~@ 5280 N Hub N side~~
- ~~@ 7893.0 N Hub, west~~
- ~~1329.50 N Hub, East~~
- ~~2219.90 N Hub, west~~
- ~~3140.20 N "~~
- ~~4393.30 N Hub,~~